



# Artisan Scientific

QUALITY INSTRUMENTATION ... GUARANTEED

## Looking for more information?

Visit us on the web at <http://www.artisan-scientific.com> for more information:

- Price Quotations
- Drivers
- Technical Specifications, Manuals and Documentation

## Artisan Scientific is Your Source for Quality New and Certified-Used/Pre-owned Equipment

- Tens of Thousands of In-Stock Items
- Hundreds of Manufacturers Supported
- Fast Shipping and Delivery
- Leasing / Monthly Rentals
- Equipment Demos
- Consignment

### Service Center Repairs

Experienced Engineers and Technicians on staff in our State-of-the-art Full-Service In-House Service Center Facility

### InstraView™ Remote Inspection

Remotely inspect equipment before purchasing with our Innovative InstraView™ website at <http://www.instraview.com>

### We buy used equipment! We also offer credit for Buy-Backs and Trade-Ins

Sell your excess, underutilized, and idle used equipment. Contact one of our Customer Service Representatives today!

Talk to a live person: 888-88-SOURCE (888-887-6872) | Contact us by email: [sales@artisan-scientific.com](mailto:sales@artisan-scientific.com) | Visit our website: <http://www.artisan-scientific.com>

## B550-101 / 115 VAC Output Module DATA SHEET

The Gould B550-001, 115 VAC Output Module consists of four independent and isolated output circuits.

### FEATURES

- Four 115 VAC output circuits per module
- 2 Amp current rating per output
- Circuits optically isolated from logic
- Zero-crossover switching
- Output status indicators
- Blown fuse indicators
- Simple fuse replacement
- Transient protection
- Easy installation
- Removed and replaced without disturbance to field wiring
- May be mounted in full length, 8 module housing (B545) or half-high, 4 module housing (B546)
- UL listed and CSA certified
- Operates at 0 to 60°C
- Operates from 0 to 95% relative humidity (non-condensing)



### GENERAL DESCRIPTION

The Gould B550-001, 115 VAC Output Module converts logic signals used within the Gould 184/384, 484, and 584 Controllers into four independent 115 VAC outputs. Each output is capable of driving a variety of loads up to two Amperes. When using the 484 Controller, the 500 series modules are attached directly; an interface assembly (J540) is required with the 184/384 and 584 Controllers.

An output status indicator and blown fuse indicator lamp accompanies each output circuit. The appropriate indicator lights when either the circuit is ON, or a fuse has blown. All output circuits are optically isolated from the controller's logic. This prevents any damage resulting from severe voltage transients prevalent in an industrial

environment. Self-contained damping networks and voltage limiting varistors suppress line voltage spikes and prevent false triggering.

The four output circuits are divided into two groups. Each group, containing two circuits, can be driven by different 115 VAC sources. The module uses four triac devices to switch the loads of the user supplied AC line.

The B550 Output Module measures 4.44 cm x 8.38 cm x 16.51 cm and weighs about .45 kg. User connections are made to standard barrier strips on the B545 or B546 I/O housing. The module is then secured to the housing via a sliding latch mechanism. This configuration allows a quick replacement of modules without disturbing field wiring.

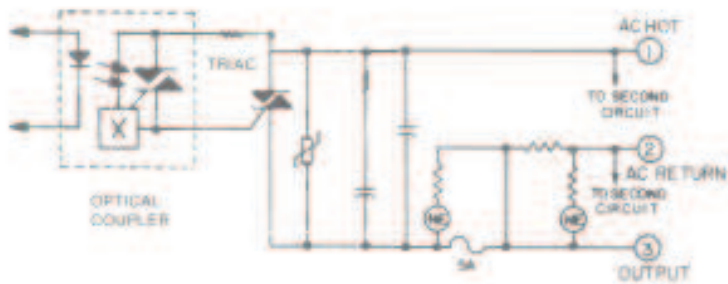

B550 115 VAC Output Module  
Simplified Schematic

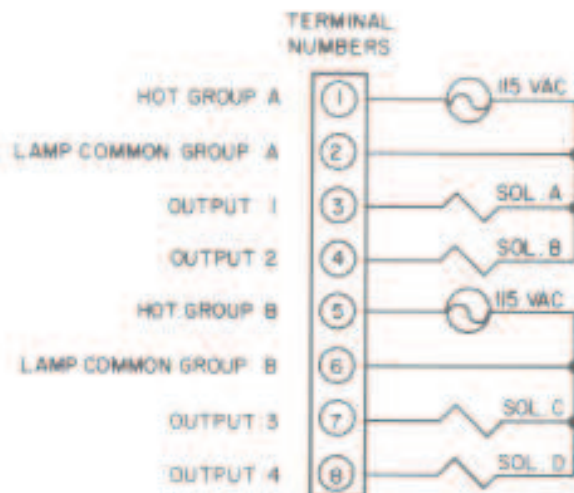

B550 115 VAC Output Module  
Terminal Numbering and Connections

## SPECIFICATIONS

### Load Ratings

|                   |   |
|-------------------|---|
| ON Current        | 10mA to 2A<br>continuous per output         |
| Inrush Current    | 15A (max) for 10ms<br>5A (max) for 100ms    |
| Working Voltage   | 80 to 130 VAC<br>40 to 70 Hz                |
| Transient Voltage | 200 VAC for one cycle<br>150 VAC per 10 sec |
| On Voltage Drop   | Approx 1 VAC at 2A                          |
| Off Load Current  | 5mA (max)                                   |

### Circuit Characteristics

|                         |   |
|-------------------------|---|
| Topology                | 4 outputs per module<br>2 outputs per AC supply     |
| Isolation Voltage       | 1500 VAC RMS for 1 sec.                             |
| Response Time           | ON to OFF, 8.3ms (max)<br>OFF to ON, 10.0ms (max)   |
| Fusing                  | One 5A fuse per output                              |
| Output Status Indicator | One neon lamp per output<br>Lamp ON when output ON  |
| Fuse Indicator          | One neon lamp per output<br>Lamp ON when fuse blown |

## NOTES



# Artisan Scientific

QUALITY INSTRUMENTATION ... GUARANTEED

## Looking for more information?

Visit us on the web at <http://www.artisan-scientific.com> for more information:

- Price Quotations
- Drivers
- Technical Specifications, Manuals and Documentation

## Artisan Scientific is Your Source for Quality New and Certified-Used/Pre-owned Equipment

- Tens of Thousands of In-Stock Items
- Hundreds of Manufacturers Supported
- Fast Shipping and Delivery
- Leasing / Monthly Rentals
- Equipment Demos
- Consignment

### Service Center Repairs

Experienced Engineers and Technicians on staff in our State-of-the-art Full-Service In-House Service Center Facility

### InstraView™ Remote Inspection

Remotely inspect equipment before purchasing with our Innovative InstraView™ website at <http://www.instraview.com>

### We buy used equipment! We also offer credit for Buy-Backs and Trade-Ins

Sell your excess, underutilized, and idle used equipment. Contact one of our Customer Service Representatives today!

Talk to a live person: 888-88-SOURCE (888-887-6872) | Contact us by email: [sales@artisan-scientific.com](mailto:sales@artisan-scientific.com) | Visit our website: <http://www.artisan-scientific.com>